

Cochituate Rail Trail Spur / Speen Street Crossing Alternative Analysis

Alternative 1	Tunnel Crossing Connecting to Shared-Use Path
Alternative 2	Tunnel Crossing Connecting to Parking Deck D
Alternative 3	Bridge Crossing with Direct Ramps on Both Sides
Alternative 4	Bridge Crossing with Switchback Ramps on Both Sides
Alternative 5	At-Grade Crossing, with Modified IN Home Furnishing Access
Alternative 6	At-Grade Crossing, without Modified IN Home Furnishing Access
Figure XS-1	Utilities Plan
Figure XS-2	Utilities Plan

Prepared for:

Town of Natick and
General Growth Properties

Prepared by:

Vanasse Hangen Brustlin, Inc.

Date: June 2, 2005

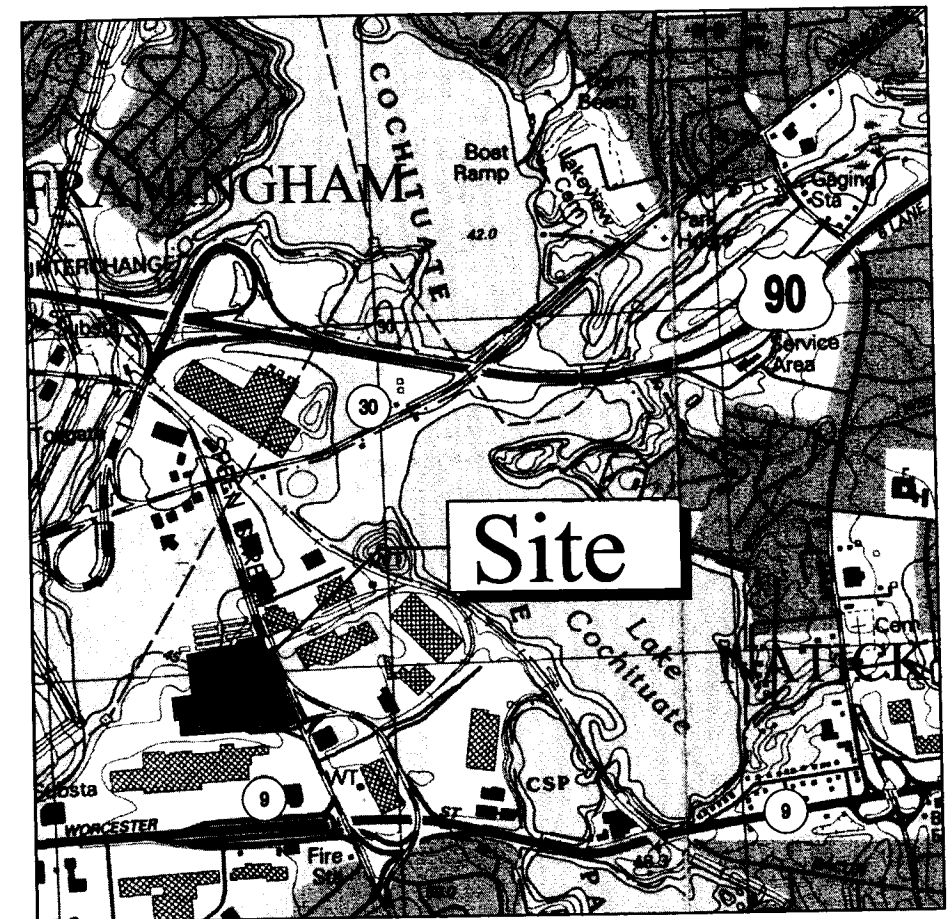

Locus Map



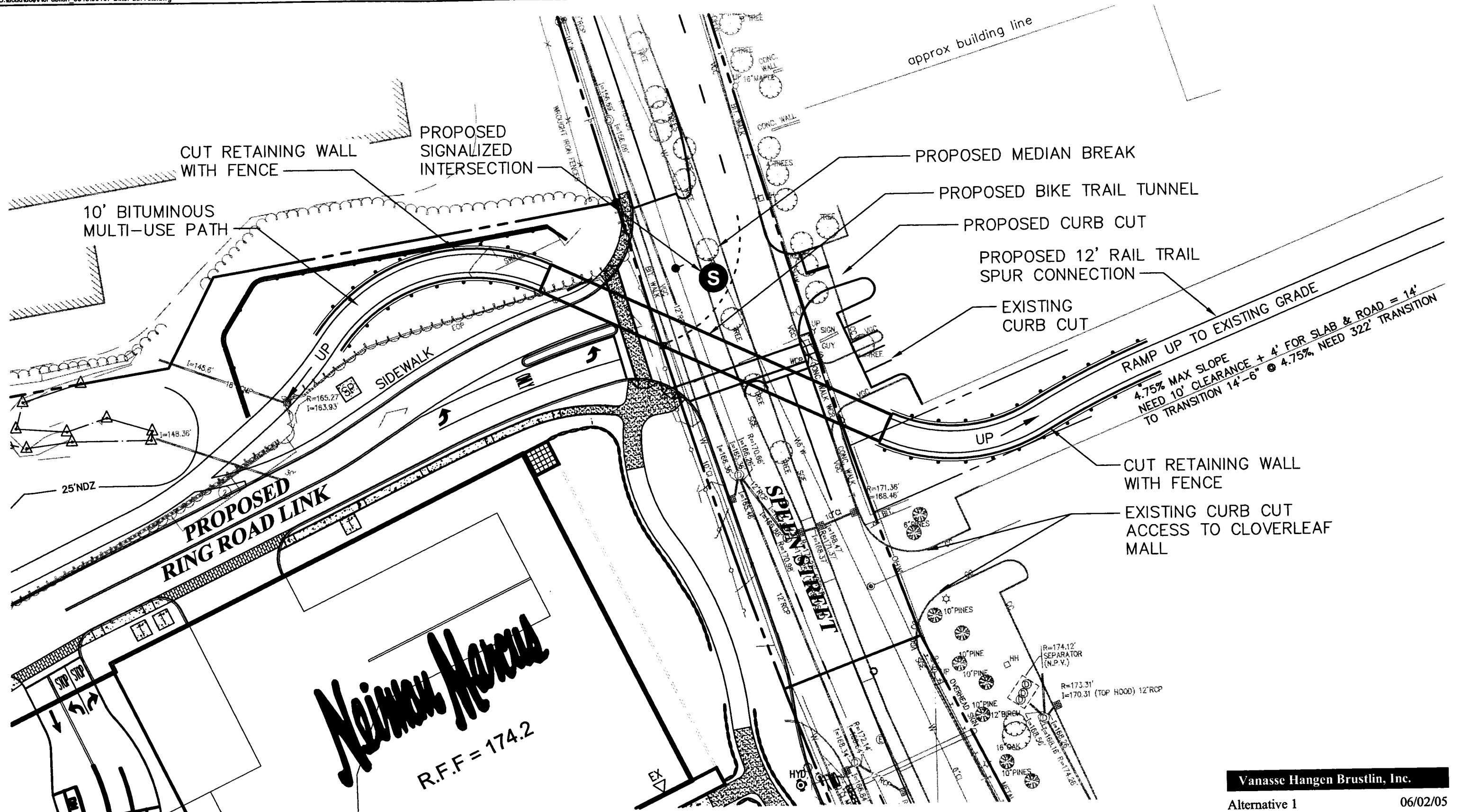

Neiman Marcus
R.F.F. = 174.2

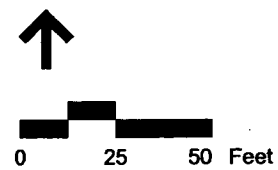

Vanasse Hangen Brustlin, Inc.

Alternative 1 06/02/05

Tunnel Crossing
Connecting to Shared-Use Path

Rail Trail Spur Crossing at Speen Street

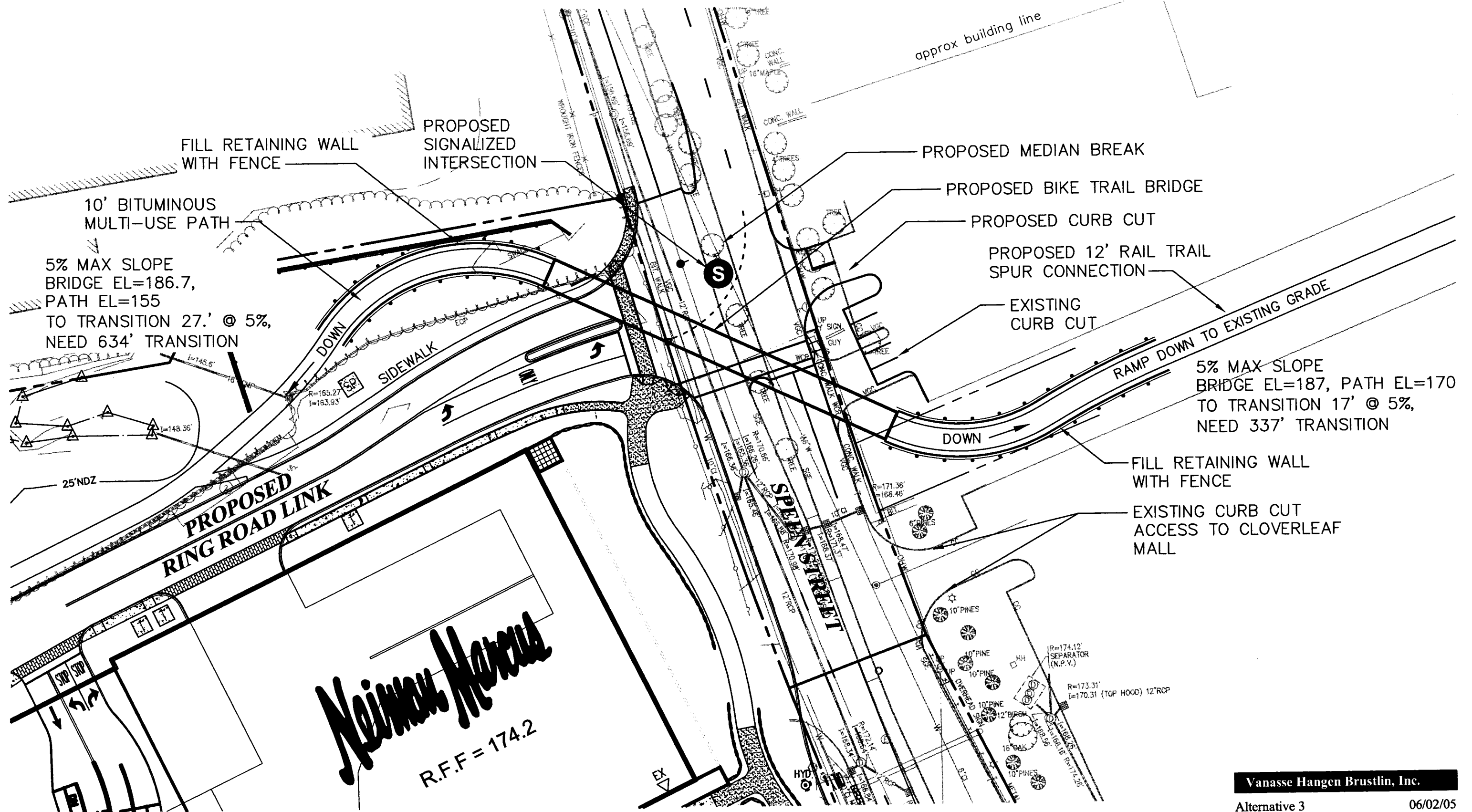

Vanasse Hangen Brustlin, Inc.

Alternative 3 06/02/05

Bridge Crossing with Direct Ramps on Both Sides

Rail Trail Spur Crossing at Spenn Street

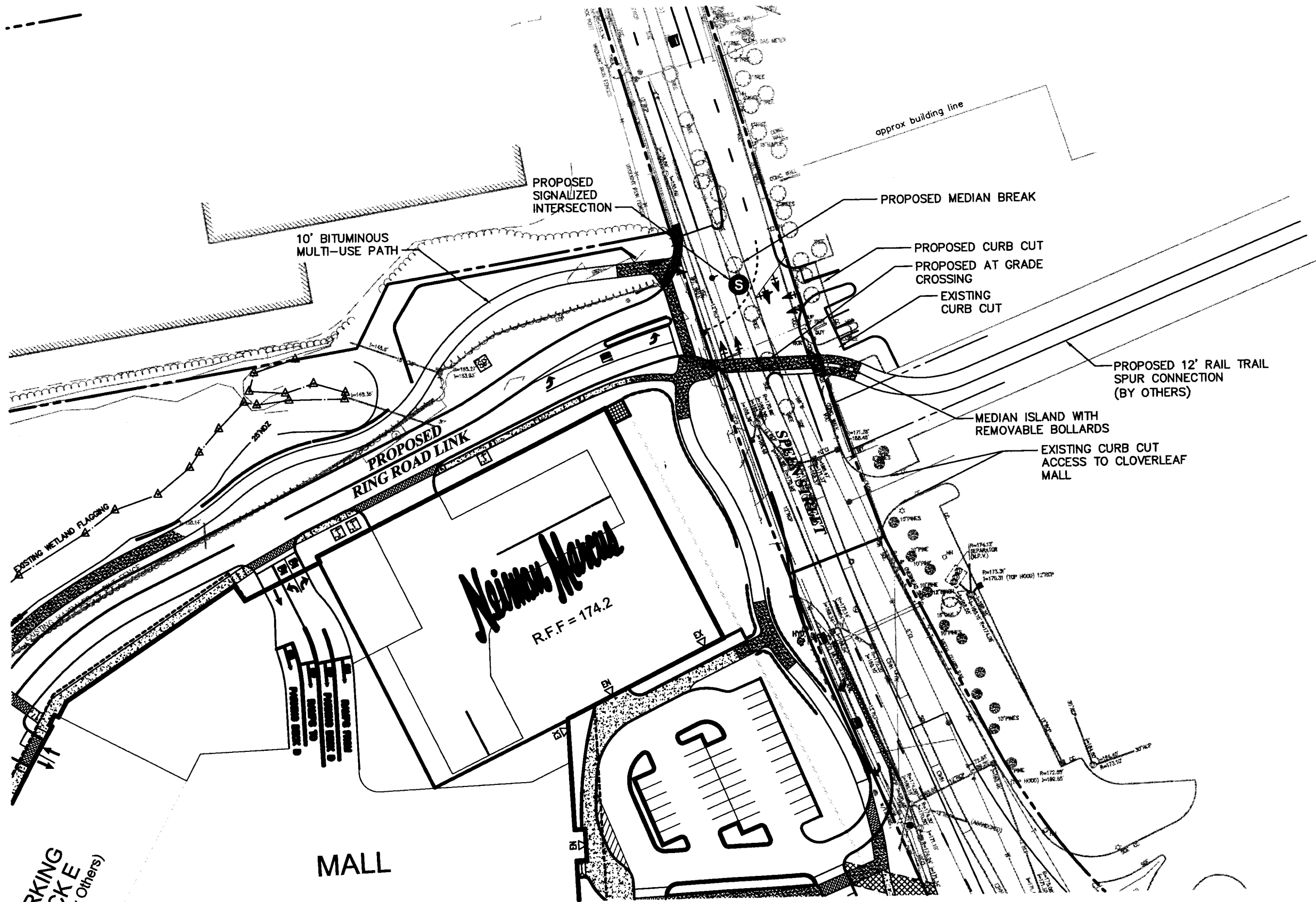

PARKING (Others)



0 25 50 Feet

Vanasse Hangen Brustlin, Inc.

Alternative 5

06/02/05

At-Grade Crossing, with Modified IN Home Furnishing Access

Rail Trail Spur Crossing at Spenn Street

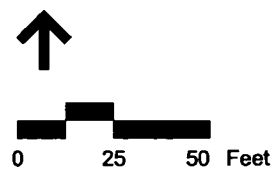
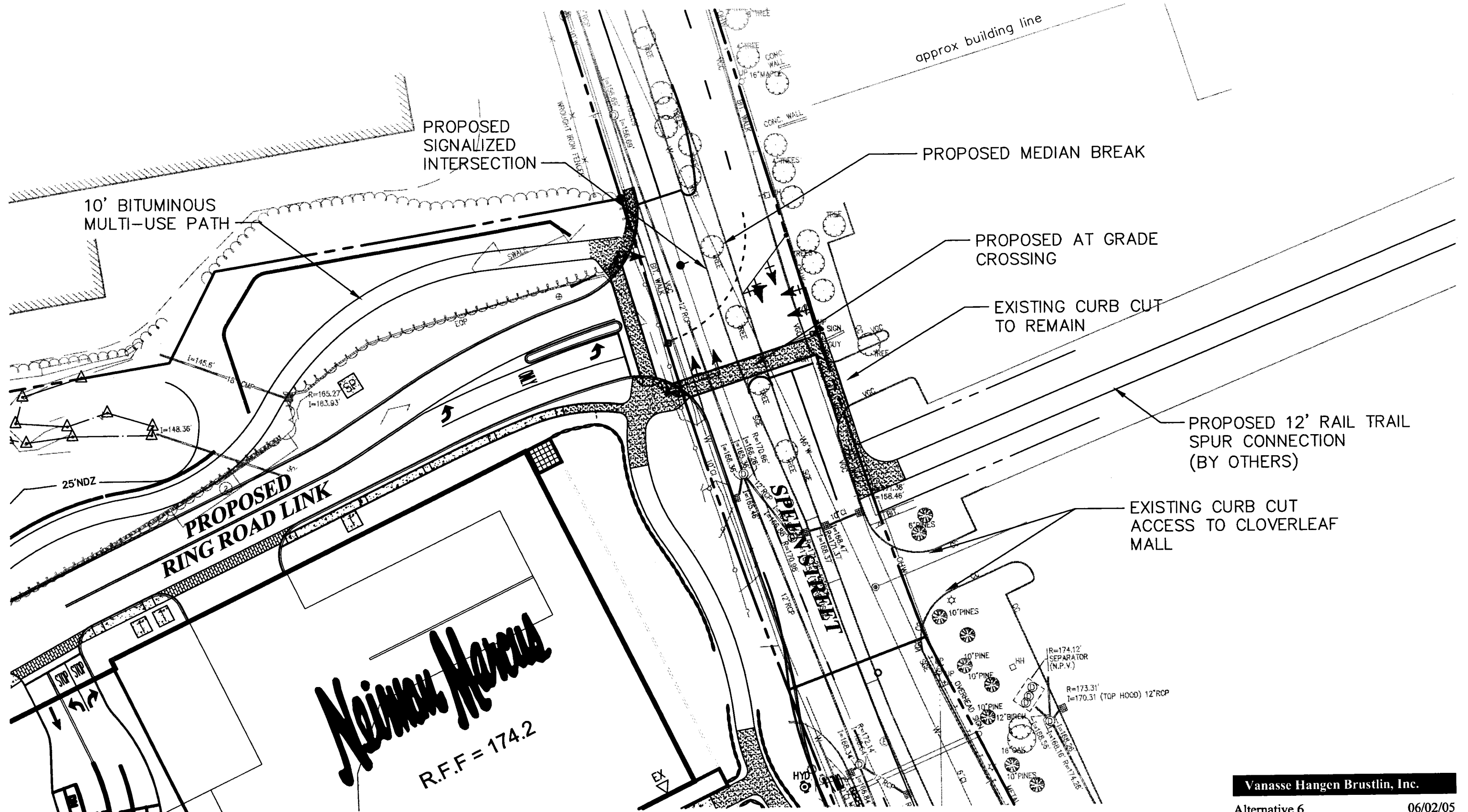

Vanasse Hangen Brustlin, Inc.

Alternative 6 06/02/05

At-Grade Crossing, without
Modified IN Home Furnishing Access

Rail Trail Spur Crossing at Speen Street

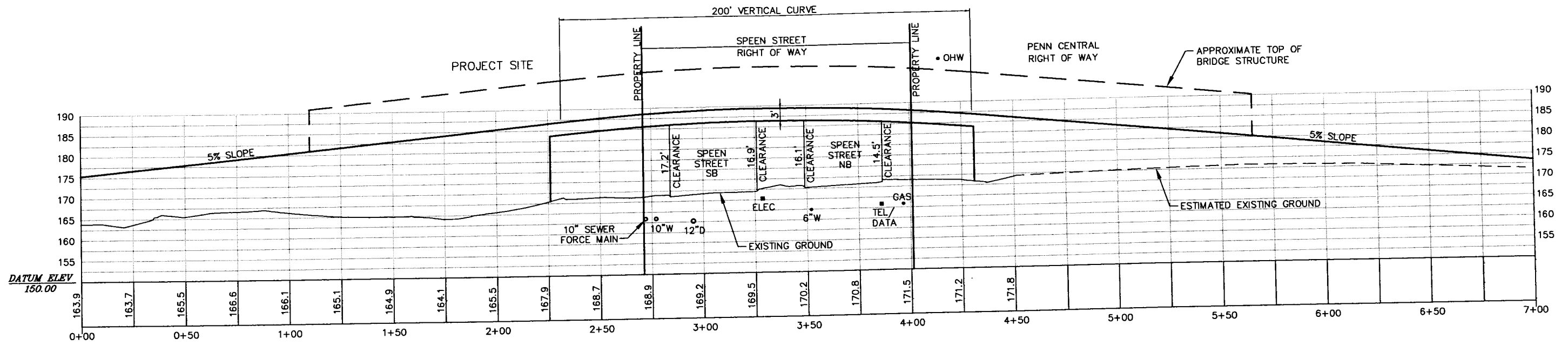

REFERENCE ALTERNATIVE 3

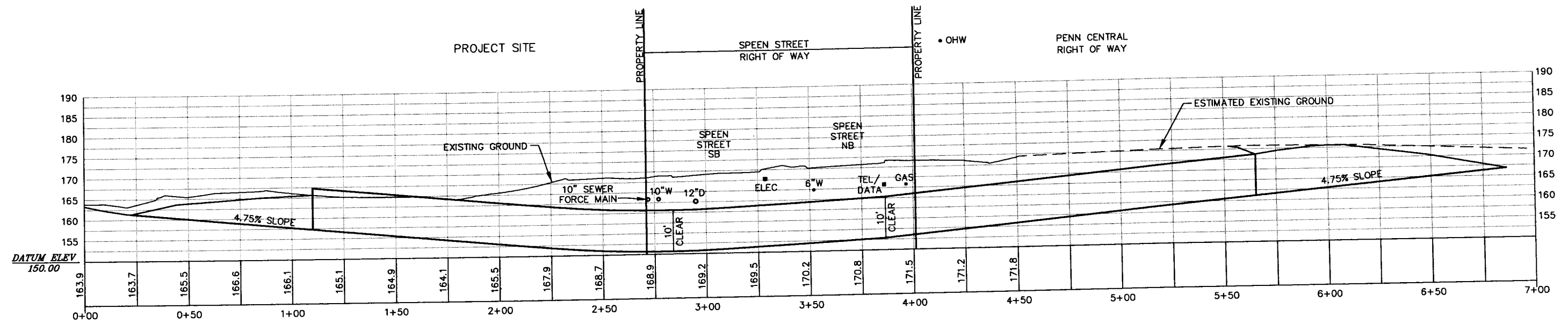

REFERENCE ALTERNATIVE 1

Vanasse Hangen Brustlin, Inc.

Figure XS-1

06/02/05

Utilities Plan

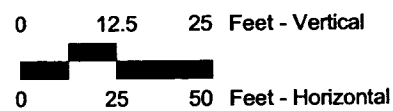

Rail Trail Spur Crossing at Speen Street

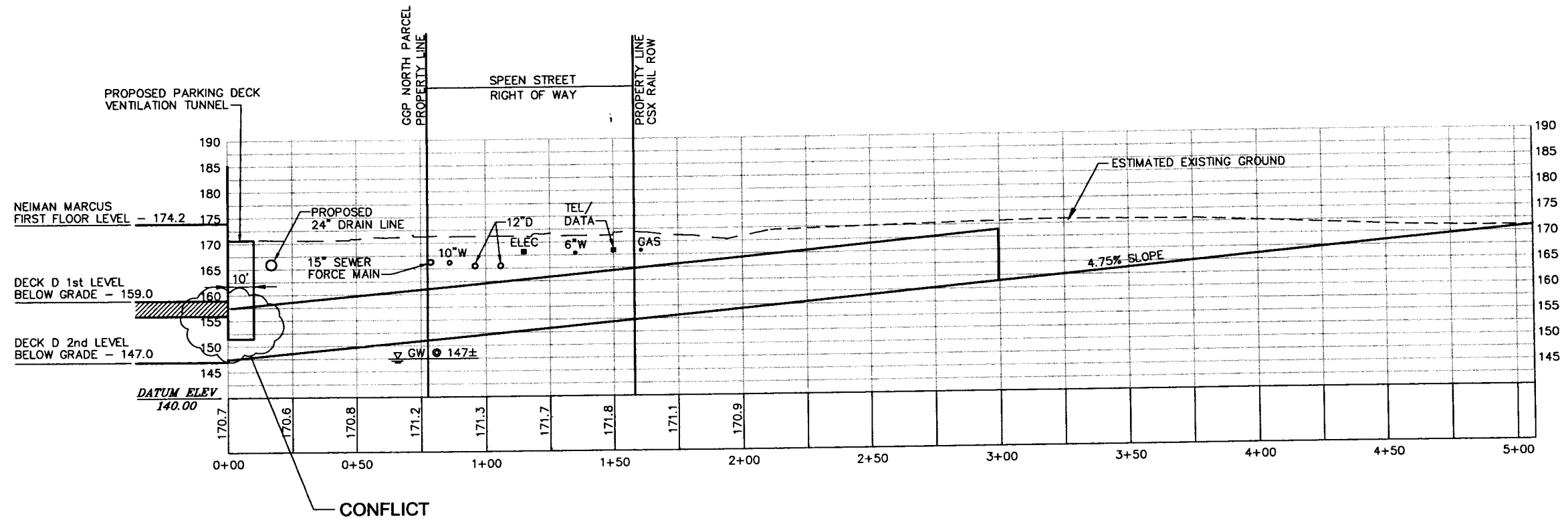

REFERENCE ALTERNATIVE 2

Vanasse Hangen Brustlin, Inc.

Figure XS-2

06/02/05

Utilities Plan

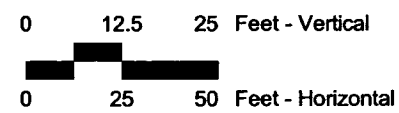

Rail Trail Spur Crossing at Speen Street